

Rev	Description	Date
0	New Drawing	2022/02/17

SPECIFICATIONS

Material:

Insulator: Glass filled PA6T (UL94V-0),
 Black Contacts: Brass
 Plating: Au or Sn over 30 μ" Ni

Electrical Characteristics:

Contact Resistance: 20mΩ Max.
 Insulator Resistance: 1000MΩ Min.
 Withstanding Voltage: AC 500V
 Current Rating: 1.0 AMP
 Operating Temperature range: -40°C to +105°C
 Resistance to Soldering Heat: 255°C ± 5°C
 Spacing: 1.27
 Salt spray test: 24H

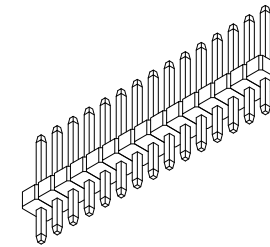
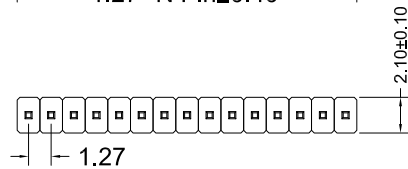
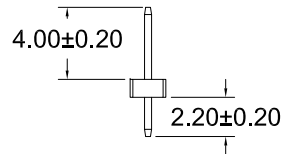
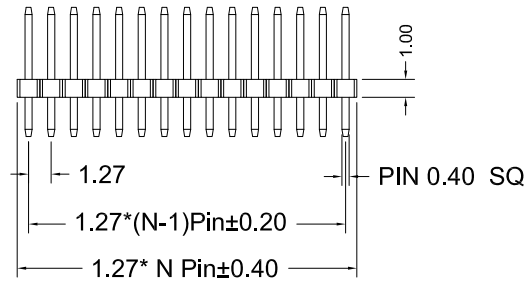
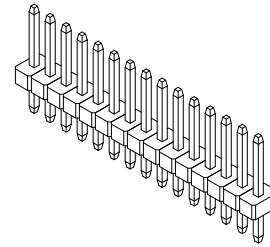
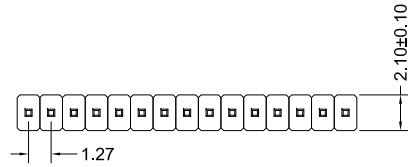

PCB LAYOUT

RONMEE

榮國工業股份有限公司
 Ronmee Industrial Corporation

Tolerance Angle ± 5° x. ± 0.50 x. x ± 0.30 x. x. x ± 0.10 x° ± 1°	Projection 	1.27 Single Base Female Header 1.27 單排排針		
	Drawn:	Joey.Lin	P/N:	PH1.27XXP/1GF-7.2AR
	Checked:	C.L.Jang	File No:	
	Approved:	R.X.Lin	Unit: mm.	Sheet: 1/1.